

UNPLATTED
#3000 OLD CENTRE
COLONIAL INVESTMENT CO.
ZONED PD

UNPLATTED
#2750 OLD CENTRE
SPYGLASS DEV. OF PORTAGE, LLC
ZONED PD

UNPLATTED
#2700 OLD CENTRE
MPK HOLDINGS, LLC
ZONED PD

R.O.W. _____ R.O.W.

OLD CENTRE ROAD

NORTH LINE, NW 1/4, SEC. 20

R.O.W.

N 89°59'49" W 322.00'

CROSSWALK TO REMAIN
(NOT SHOWN)

N 01°46'18" E 23.56'(R)
N 01°45'41" E 23.57'(M)

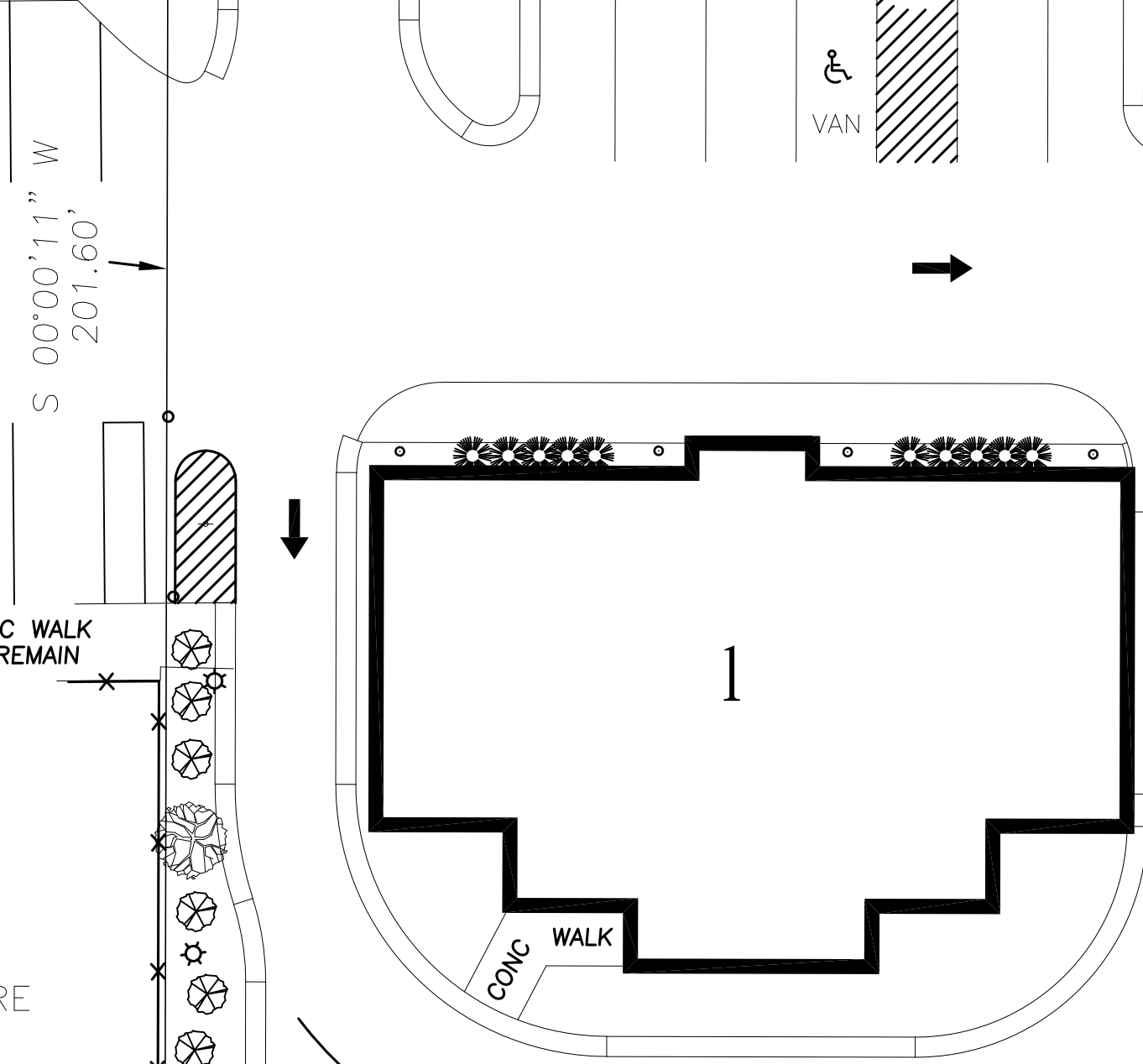

UNPLATTED
#2900 WEST CENTRE
Y.M.C.A.
ZONED OS-1

EXISTING
TENNIS COURT
AREA

CENTER LEFT TURN LANE

TWO WESTBOUND LANES
WEST CENTRE AVE.
(CITY OF PORTAGE JURISDICTION, 100.0' WIDE PUBLIC RIGHT OF WAY)
TWO EASTBOUND LANES

R.O.W.

2700 CENTER SITE PLAN

NO.	TENANT	FRONTAGE	S.F.AREA
1	FIRST NATIONAL BANK OF MI	74'-8"	3,177

OVERALL SITE PLAN
SCALE: N.T.S.

2700 CENTER
FIRST NATIONAL BANK OF MICHIGAN
2700 CENTER AVENUE
PORTAGE, MICHIGAN

MEYER C. WEINER CO.
700 MALL DRIVE
PORTAGE, MICHIGAN 49782
PHONE 269.323.2441
FAX 269.323.3262

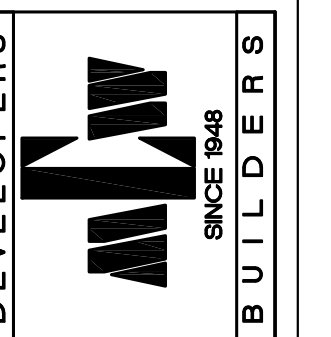

REVISIONS:

DATE: .
PROJECT: .

SD1.0